

# SMART mini-dome extérieur IP 3MP, 1080p/25ims, 1/3" progressive scan CMOS

Réf. : VZ-2CD4332FWD-IS / VZ-2CD4332FWD-IZS

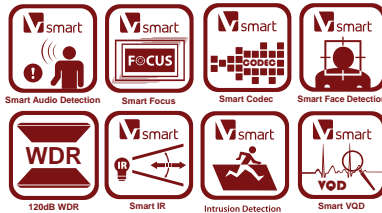

## Key features

- Up to 2048 x 1536 high resolution
- Full HD1080p video
- Smart Codec
- 120dB WDR, 3D DNR
- Triple streams
- On-board storage, up to 64GB
- Smart Focus: Motorized VF lens (-Z)
- Smart VQD
- Smart Facial Detection
- Intrusion Detection
- Built-in heater & fan
- Defog
- EIS (Electronic Image Stabilization)

## Dimension (unit: mm)

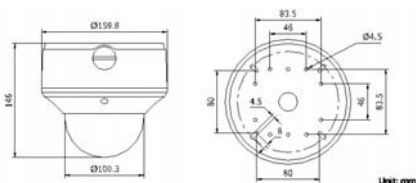

| Camera                  |   |
|-------------------------|---|
| Image sensor            | 1/3" progressive scan CMOS  |
| Min. illumination       | 0.1 lux@F1.2, AGC on, 0.14 lux@F1.4, AGC on, 0 lux with IR  |
| Shutter time            | 1s ~ 1/100,000s   |
| Slow shutter            | Yes   |
| Lens                    | 2.8 ~ 12mm @F1.4, angle of view: 91.2° ~ 28.3° (-Z: motorized VF lens)  |
| Lens mount              | Φ14   |
| Angle adjustment        | Pan: 0° ~ 355°, tilt: 0° ~ 75°, rotation: 0° ~ 355°   |
| Auto iris               | DC drive  |
| Day & night             | ICR (Auto/Schedule/Alarm Trigger)   |
| Digital noise reduction | 3D DNR  |
| Wide dynamic range      | 120dB WDR   |
| Compression standard    |   |
| Video compression       | H.264 / MPEG4 / MJPEG   |
| H.264 codec profile     | Baseline profile / main profile / high profile  |
| Video bit rate          | 32 Kbps ~ 16 Mbps   |
| Audio compression       | G.711 / G.726 / MP2L2 *only for -S model  |
| Audio bit rate          | 64Kbps (G.711) / 16Kbps (G.726)   |
| Image                   |   |
| Max. resolution         | 2048 x 1536   |
| Frame rate              | 50 Hz: 20fps (2048 x 1536), 25fps (1920 x 1080), 25fps (1280 x 720)<br>60 Hz: 20fps (2048 x 1536), 30fps (1920 x 1080), 30fps (1280 x 720)                              |
| 3rd stream              | Independent setting, up to:<br>50Hz: 20fps (2048 x 1536), 60Hz: 20fps (2048 x 1536)   |
| Image settings          | Rotate mode, saturation, brightness, contrast, grayscale adjustable through client software or web browser  |
| BLC                     | Yes, zone configurable  |
| Defog                   | Yes   |
| EIS                     | Yes   |
| Picture overlay         | 128 x 128, BMP 24bit, zone configurable   |
| ROI                     | Yes, up to 4 configurable areas.  |
| Network                 |   |
| Network storage         | NAS   |
| Alarm trigger           | Intrusion detection, Defocus detection, Motion detection, Face detection, Dynamic analysis, Tampering alarm, Network disconnect, IP address conflict, Storage exception |
| Protocols               | TCP/IP, ICMP, HTTP, HTTPS, FTP, DHCP, DNS, DDNS, RTP, RTSP, RTCP, PPPoE, NTP, UPnP, SMTP, SNMP, IGMP, 802.1X, QoS, IPv6, Bonjour (SIP optional)                         |
| Security                | User authentication, watermark, IP address filtering, anonymous access, reset   |
| System compatibility    | ONVIF, PSIA, CGI  |
| Interface               |   |
| Communication interface | 1 RJ45 10M / 100M ethernet port   |
| Video Output            | 1 Vp-p composite output (75 Ω/RCA, for lens adjustment when installation)   |
| On-board storage        | Micro SD/SDHC/SDXC card slot, up to 64GB  |
| General                 |   |
| Operating conditions    | -30°C ~ 60°C (-22°F ~ 140°F), humidity 95% or less (non-condensing)<br>-H: -40°C ~ 60°C (-40°F ~ 140°F), with smart heater on   |
| Power supply            | 24 VAC ± 10%, PoE (802.3af)   |
| Power consumption       | Max. 12W<br>-Z/-H: Max. 13W   |
| IR range                | Up to 30m   |
| Ingress protection      | IP66  |
| Impact protection       | IEC60068-2-75Eh, 50J; EN50102, up to IK10   |
| Dimensions              | Φ 159.8 x 146 mm (Φ 6.29" x 5.75")  |
| Weight                  | 2100 g (4.62 lbs)   |

\* -Z: Motorized VF lens

\* -S: 1-ch audio I/O, 2-ch alarm I/O

and 1-ch RS-485 interface



Réf. : VZ-1273ZJ-160B



Réf. : VZ-1275ZJ



Réf. : VZ-1276ZJ